

TECHNICAL BULLETIN

Date: September 26, 2016

**Subject: Insulation Installation Instructions – Under Roof Sheathing – Prescriptive Path
SMARTBATT or Sustainable Unfaced Insulation**

The following installation instructions are supplemental to *CertainTeed's Sustainable Insulation Installation Manual*, which is available for download at our website at www.certainteed.com/resources/30-45-072.pdf.

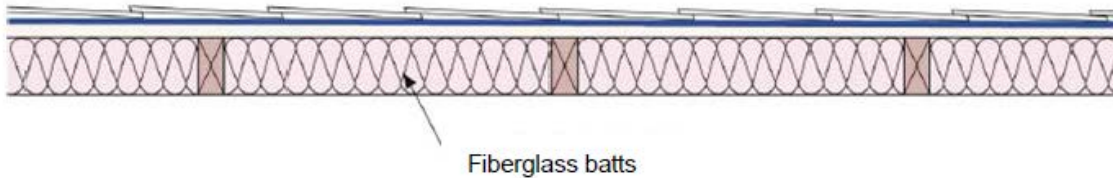

Image source: Building Science Corporation

BEFORE INSTALL:

- It is important that insulation be correctly sized for the cavity and fit snugly at the ends; do not apply too much pressure, which could lead to compression. When a batt is compressed the thermal value is compromised.
- Wherever a batt is too short to fill a cavity, a piece should be cut to size to fill the gap.
- When the batt is too long, it should be cut to fit properly and not forced to fit.

1. **SMARTBATT fiberglass batt with flange stapling:**

- Start at one side of the attic ceiling and work toward the center.
- Place and hold Smartbatt gently, but firmly in between rafters with the blue smart vapor retarder installed toward the warm-in-winter side of the house, or facing down and away from roof sheathing.
- Working down the flange, inset staple about 8 inches apart until you reach the end of the batt. This will prevent gaps and fishmouths between the flanges and rafters. Go back and staple the opposing side's flange in the same fashion.
- If more than one batt is used to fill the cavity, make sure the batts are butted together. Overlap blue smart vapor retarder on each batt to conceal seam.

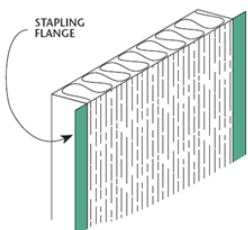

DISCLAIMER: Technical Services recommendations are provided solely for the information of the project designer, architect, engineer or contractor. It is the responsibility of the project designer, architect, engineer and/or contractor to check local code requirements - prior to installation of any CertainTeed product - to assure suitability and code compliance of any design or recommendation described above. CertainTeed is not responsible for applications that do not meet jurisdictional code requirements.



TECHNICAL BULLETIN

- If rafters are not evenly spaced, measure cavity and cut batt to measured size. Since cutting will eliminate one flange, you will need to cut batt to size, but leave an additional inch of facing attached to create your second flange. Install and staple per steps above.



(1) *Sustainable unfaced fiberglass batt with wire fasteners:*

- a. Start at one side of the attic ceiling and work toward the center.
- b. Gently place and hold the insulation in between the rafters with R-Value ink markings printed towards you. If rafter area changed in size, measure and cut to size.
- c. To prevent sagging, use straight, rigid wire fasteners (preferably galvanized), with pointed ends to securely hold insulation in place. Wedge the fasteners in between the rafters, bowing the fastener upward so the insulation presses gently against the under roof sheathing.
 - i. Space the fasteners 12 inches apart and not more than 6 inches from the end of the insulation to ensure placement and to prevent sagging.
 1. Fasteners are made for joist spacing of 12, 16, 18, 20 and 24 inches



For more information regarding CertainTeed's comprehensive line of insulation products, please visit our website at www.certainteed.com/insulation

DISCLAIMER: Technical Services recommendations are provided solely for the information of the project designer, architect, engineer or contractor. It is the responsibility of the project designer, architect, engineer and/or contractor to check local code requirements - prior to installation of any CertainTeed product - to assure suitability and code compliance of any design or recommendation described above. CertainTeed is not responsible for applications that do not meet jurisdictional code requirements.

